

PIG Steel Modular Spill Deck

Instructions – Assembly of two modular spill decks (PAK644)

- Step 1** Remove two plug assemblies (7) from one side of the modular spill deck (1) on both of the units.
- Step 2** Align the units so that the holes will match up to each other. Leave about a 6" gap between the units.
- Step 3** Take a 1 ¼" hex nut (4) and screw it on to the 1 ¼" pipe nipple (5) about ½". Place this through one of the holes on the inside of the spill deck.
- Step 4** Repeat step 3 for the other hole.
- Step 5** Place the neoprene gasket (B) over the pipe nipples on the outer side of the spill deck.
- Step 6** Carefully pull the two spill decks together, making sure the neoprene gasket stays between the decks and the pipe nipples go through the holes of the other deck.
- Step 7** Once the two spill decks are together and everything is in line, place the other 1 ¼" hex nuts on the pipe nipples.

- Step 8** Take the wrench from each spill deck and tighten the hex nuts evenly so that the pipe nipple is divided equally between the two decks. Make sure the hex nuts are tight.
- Step 9** Place the modular channels (3) over the edge where the two spill decks meet.
- Step 10** Place the modular grates (2) in the spill decks.

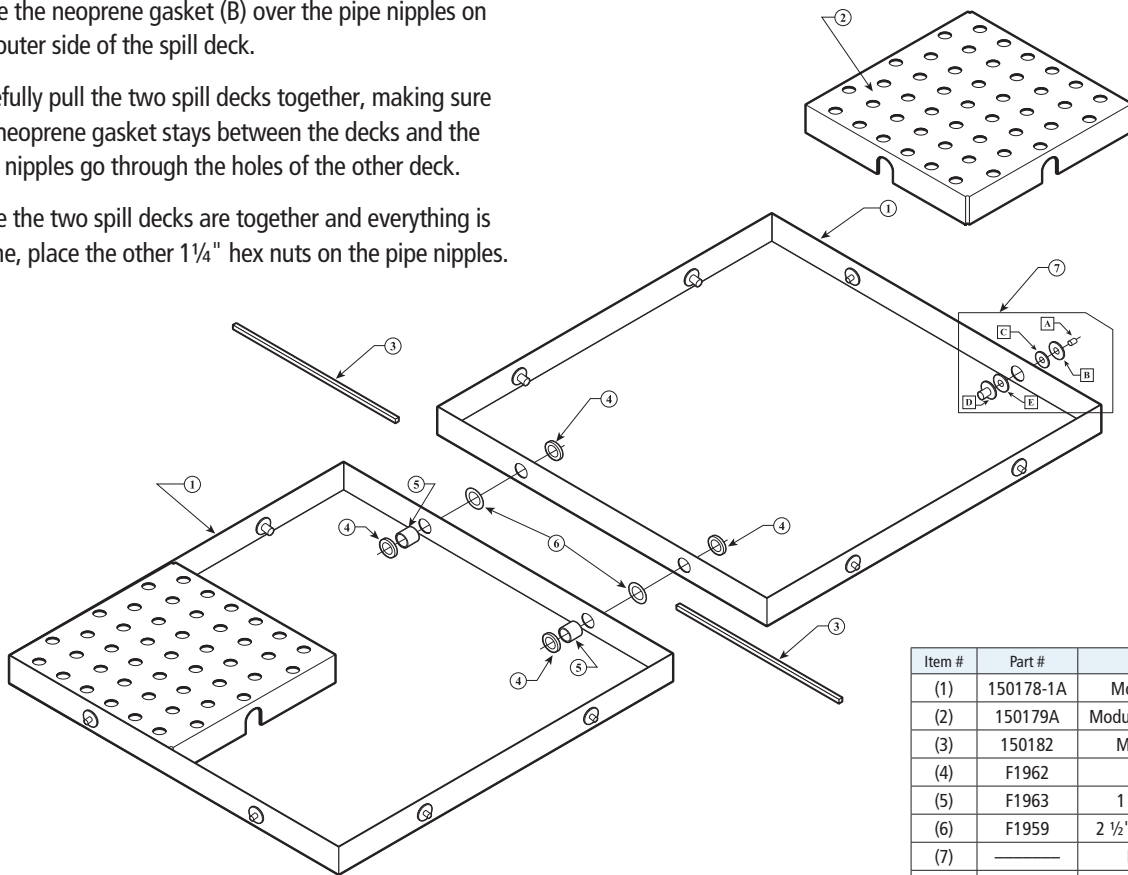

NOTE: Make sure all plug assemblies are tight before putting this product in use.

Item #	Part #	Description
(1)	150178-1A	Modular Spill Deck
(2)	150179A	Modular Spill Deck Grate
(3)	150182	Modular Channel
(4)	F1962	1 ¼" Hex Nut
(5)	F1963	1 ¼" Pipe Nipple
(6)	F1959	2 ½" Neoprene Gasket
(7)	—	Plug Assembly
(A)	F1464	¾" – 16UNC x ¾" Bolt
(B)	F1958	2" O.D. Steel Washer
(C)	F1969	1 ¾" O.D. Steel Washer
(D)	P1039	Nut Assembly
(E)	P1961	2" O.D. Neoprene Washer
—	150193	Modular Wrench



New Pig

One Pork Avenue
Tipton, PA 16684-0304

newpig.com

North America: **1-800-468-4647**

Europe: **+31 (0)76 596 92 50**

China: **+86-21-400 921 5178**

PIG, PIG logo are registered trademarks in USA and other countries. See tm.newpig.com

UK: **0800 919 900**

Outside North America: **+1-814-684-0101**

502433 / 351772