



**VESTIL MANUFACTURING CORP.**  
 2999 North Wayne Street, P.O. Box 507, Angola, IN 46703  
 Telephone: (260) 665-7586 -or- Toll Free (800) 348-0868  
 Fax: (260) 665-1339  
[www.vestilmfg.com](http://www.vestilmfg.com) e-mail: [sales@vestil.com](mailto:sales@vestil.com)

## NPCT Series Nesting Platform Carts Instruction Manual



**Receiving Instructions:**

After delivery, IMMEDIATELY remove the packaging from the product. Inspect the product closely to determine whether it sustained damage during transport. **If damage is discovered, immediately record a complete description of the damage on the bill of lading.** If the product is undamaged, discard the packaging.

**NOTE:**

Compliance with laws, regulations, codes, and non-voluntary standards enforced in the location where the product is used is exclusively the responsibility of the end-user.

**Table of Contents**

Hazard identification with signal words.....	2
Safe Use Recommendations.....	2
FIG. 1: Exploded parts diagram & bill of materials.....	3
Specifications.....	3
Assembly.....	4
Loading Instructions.....	5
Nesting multiple carts.....	5
Inspections & Maintenance.....	5
Labeling diagram.....	5
Limited warranty.....	6

## Hazard identification with signal words

This manual uses SIGNAL WORDS to identify dangers that might arise during use. Signal words also indicate the probable seriousness of injuries that could result if the product is misused. Signal words used in this manual appear below along with their definitions.



Identifies a hazardous situation which, if not avoided, **WILL** result in DEATH or SERIOUS INJURY. Use of this signal word is limited to the most extreme situations.



Identifies a hazardous situation which, if not avoided, **COULD** result in DEATH or SERIOUS INJURY.



Indicates a hazardous situation which, if not avoided, **COULD** result in MINOR or MODERATE injury.



Identifies practices likely to result in product/property damage, such as operation that might damage the product.

Each person who assembles, uses, or maintains this product should read the entire manual **and fully understand the directions in advance. If after reading the manual you do not understand an instruction, ask your supervisor or employer for clarification, because failure to adhere to the directions in this manual might result in serious personal injury.**

## Safe use recommendations:

Material handling is dangerous. The following list identifies many unsafe activities that could occur while using the cart. However, the most effective means for preventing injury is for the end-user to exercise sound judgment at all times.



Improper or careless use of this product might result in serious personal injuries or even death.

- ***Failure to read and understand the entire manual before assembling, using or servicing the product constitutes misuse.*** Read the manual to refresh your understanding of proper use and maintenance procedures as necessary.
- DO NOT apply a load that weighs more than the maximum rated load of your cart. The rated load (capacity) appears on label 287 as shown in “Labeling diagram” on p. 5 and in the “Specifications” information on p. 3.
- DO NOT allow people to ride on the cart or the load.
- Stand clear of the deck while applying a load to it. The deck pivots from the front end. Pinch points are created as the deck lowers under a load. NEVER reach into or put any part of your body or clothing under the deck.
- DO NOT use the cart in corrosive environments. ONLY use the cart on compacted, improved surfaces capable of supporting the combined weight of the cart plus its maximum rated load.
- DO NOT perform maintenance on this cart UNLESS it is unloaded. If repairs are necessary, ONLY install manufacturer-approved replacement parts.
- ALWAYS center and evenly distribute loads on the deck. Secure loads to the deck if they are likely to roll or slide.
- DO NOT use the cart unless it is in normal operating condition. Inspect the unit before each use according to the inspection instructions on p. 5 to determine whether the unit is functioning normally.
- Before leaving the cart unattended, make sure that it will not roll on its own. Only park the cart on even, level surfaces.
- DO NOT use the cart UNLESS all labels are in place and readable (see “Labeling diagram” on p. 5).
- DO NOT modify this product in any way. Modifications automatically void the limited warranty (see p. 6) and might make the cart unsafe to use.



Proper use and maintenance are essential for this product to function properly.

- Always use this product in accordance with the instructions in this manual.
- Periodically lubricate moving parts.
- Keep the product clean & dry.
- Only use approved replacement parts. To order replacement or spare parts for this equipment, contact the factory.

**FIG. 1:** Exploded parts diagram and bill of materials

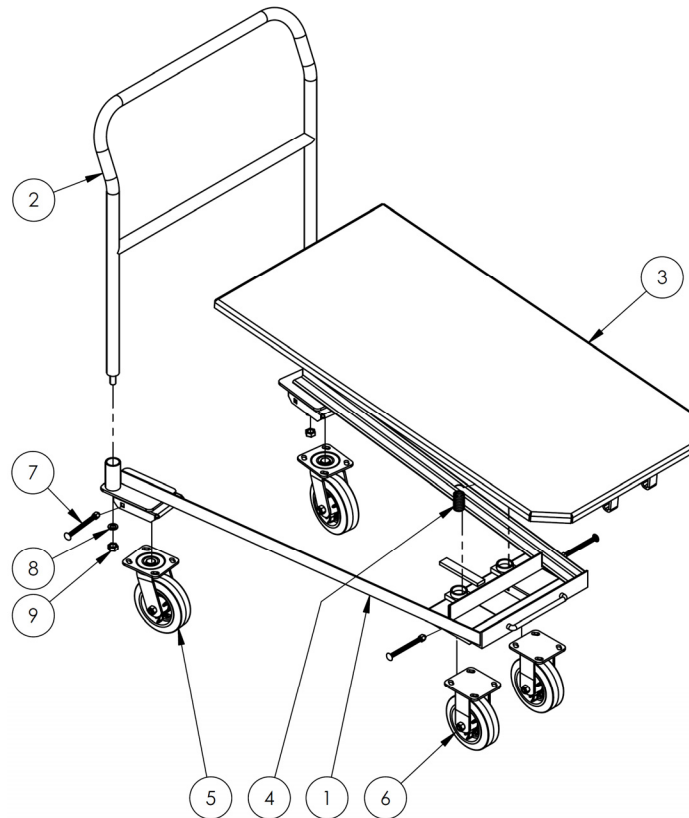

Item	Part no.	Description	Quantity
1	16-514-026	Weldment, frame	1
2	16-525-012	Weldment, handle, push handles, chromed	1
3	16-513-005	Weldment, deck	1
4	16-146-002	Spring	2
5	16-132-026	Caster, 6"x2" mold on rubber, swivel	2
6	16-132-027	Caster, 6"x2" mold on rubber, rigid	2
7	99-612-001	Caster receiver nut and bolt combination	4
8	40386	Lock washer, class ZN8M, zinc plated, M14 DIN 127	2
9	40310	Hex nut, class 8, zinc finish, M14-2.0	2

**Specifications:**

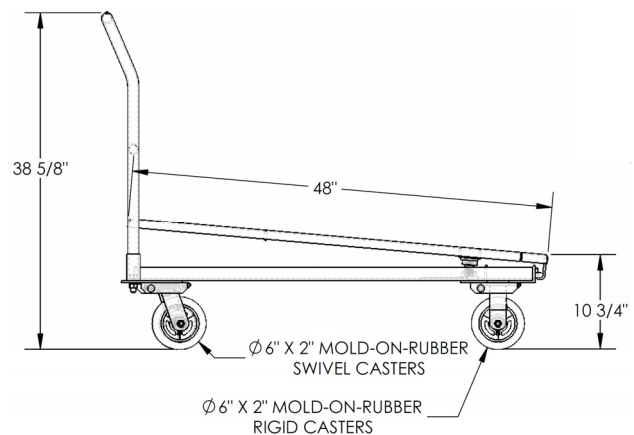
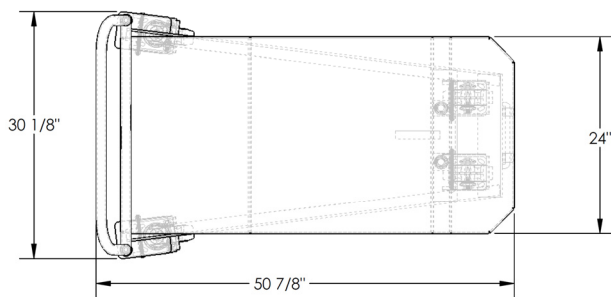

- Capacity = 1,500 lb.
- Overall width = 30<sup>1</sup>/<sub>8</sub>"
- Usable width = 24"
- Overall length = 50<sup>7</sup>/<sub>8</sub>"
- Usable length = 48"
- Overall height = 38<sup>5</sup>/<sub>8</sub>"
- 6"x2" mold-on rubber casters: 2 rigid & 2 swiveling

**Assembly:**

**Step 1:** Attach the casters to the receivers on the bottom side of the frame. Insert the caster mounting plates into the receivers. Then, insert the carriage bolts through the bolt holes in the receivers and secure them with lock nuts as diagrammed below. Place a spring in each spring cup.

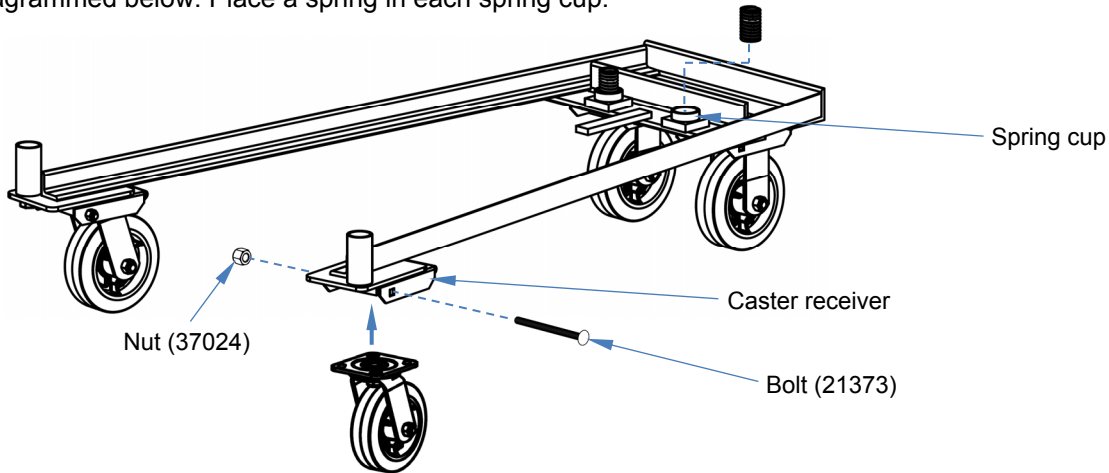

**Step 2:** Attach the deck to the frame. There are 2 J-shaped hinge brackets on the underside of front of the deck. These brackets engage the hinge bar attached to the front end of the frame. Slide the brackets into engagement with the bar and then slowly lower the deck. The tops of the springs should seat into spring cups on the underside of the deck.

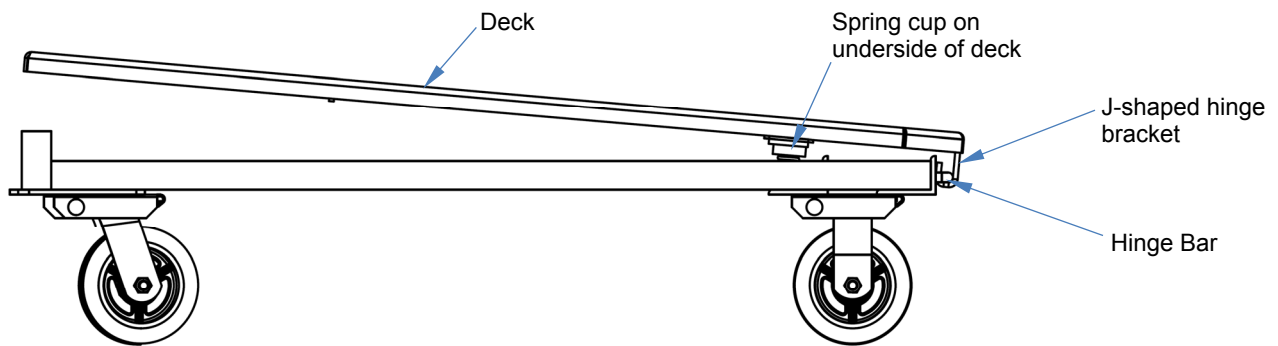

**Step 3:** Insert the legs of the handle into the handle sockets of the frame. Attach each log of the handle to its socket with an M14 lock washer (40386) and an M14 hex nut (40310).

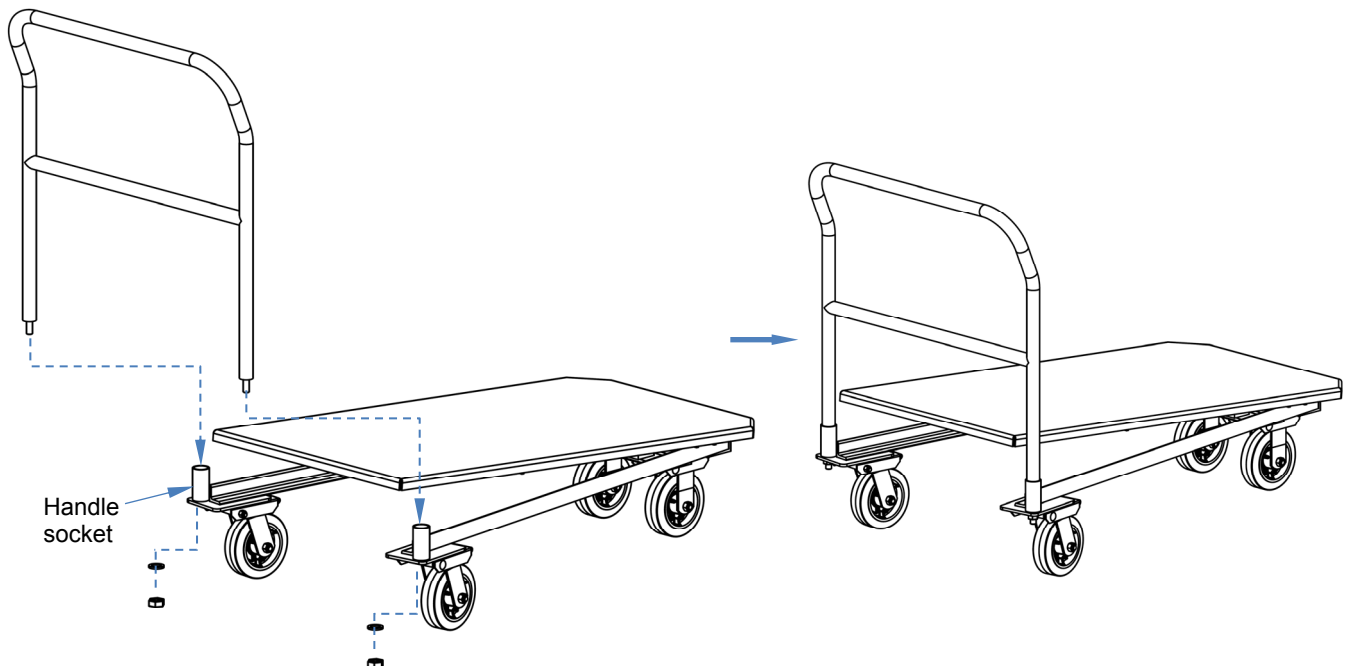

### LOADING INSTRUCTIONS:

The load capacity, which appears on the data label (see “Labeling diagram”, below, label 287) of your unit, is the maximum net weight the cart can support. All loads applied to the deck must be centered and evenly distributed. DO NOT exceed the capacity because personal injury or permanent damage to the cart might occur.

### NESTING MULTIPLE CARTS:

This cart is designed to “nest” with other units of the same model. Each cart must be unloaded and the springs must function properly to lift the free end of the deck off of the frame. To nest multiple units, push the front end of your cart into the back end of a second cart.

### INSPECTIONS & MAINTENANCE:

**NOTICE** Proper use, maintenance, and storage are essential for this product to function properly.

- o Always use this product in accordance with the instructions in this manual.
- o Keep the product clean & dry. Lubricate moving parts at least once per month.
- o ONLY use manufacturer-approved replacement parts. Vestil is not responsible for problems or malfunctions that result from the use of unapproved replacement parts.

Perform the listed inspections at least once per month.

1. Hinge brackets and hinge bar: inspect for excessive wear. Lubricate the points of contact.
2. Casters: check casters, receivers, and retaining hardware for normal condition. Each caster should roll smoothly, without wobbling, bogging, or scraping across the ground. Tighten lock nuts as necessary.
3. Deck and deck springs: confirm that the deck returns to the elevated state when unloaded. Apply a load to the deck. Listen and watch for unusual noise, motion, or binding.
4. Handle and handle fasteners: if the handle wobbles in the sockets, tighten the retaining hardware.
5. Frame: the frame should be rigid and square. Check all welds. Remove rust/corrosion and apply touch-up paint to areas where paint has chipped.
6. Labels (see “Labeling diagram” below): confirm that all labels are in place and in good, readable condition.
7. Surfaces: remove dirt and debris.

### Labeling Diagram:

Each unit should be labeled at all times as shown in the diagram below. Replace any label that is damaged and/or not easily readable. Numbers below label images in the diagram correspond to the identification number of each label.



A: Label 658

⚠ WARNING	⚠ ADVERTENCIA	⚠ AVERTISSEMENT
Do not operate or move with unstable loads DO NOT LOAD beyond rated capacity DISTRIBUTE LOAD EVENLY DO NOT sit or ride	No use a mueva con cargas inestables No cargue mas de la capacidad tasada DISTRIBUYA LA CARGA A NIVEL NO SE SIENTE o vaya en el carro	Ne pas utiliser avec une charge instable NE PAS CHARGER au-delà du débit nominale DISTRIBUER la charge régulièrement NE PAS VOUS ASSEoir OU VOUS PROMENER sur le chariot

B: Label 287

MODEL/MODÉLO/MODÈLE \_\_\_\_\_

STATIC CAPACITY (evenly distributed) \_\_\_\_\_ lbs.

LA CAPACIDAD CONSTANTE (distribuida uniformemente) \_\_\_\_\_ kgs.

CAPACITÉ STATIQUE (distribuée régulièrement) \_\_\_\_\_ kgs.

SERIAL/SERIE/SÉRIE \_\_\_\_\_

287 REV 0812

## LIMITED WARRANTY

Vestil Manufacturing Corporation (“Vestil”) warrants this product to be free of defects in material and workmanship during the warranty period. Our warranty obligation is to provide a replacement for a defective original part if the part is covered by the warranty, after we receive a proper request from the warrantee (you) for warranty service.

### Who may request service?

Only a warrantee may request service. *You are a warrantee if* you purchased the product from Vestil or from an authorized distributor AND Vestil has been fully paid.

### What is an “original part”?

An original part is a part used to make the product as shipped to the warrantee.

### What is a “proper request”?

A request for warranty service is proper if Vestil receives: 1) a photocopy of the Customer Invoice that displays the shipping date; AND 2) a written request for warranty service including your name and phone number. Send requests by any of the following methods:

Mail  
Vestil Manufacturing Corporation  
2999 North Wayne Street, PO Box 507  
Angola, IN 46703

Fax  
(260) 665-1339  
Phone  
(260) 665-7586

Email  
sales@vestil.com

In the written request, list the parts believed to be defective and include the address where replacements should be delivered.

### What is covered under the warranty?

After Vestil receives your request for warranty service, an authorized representative will contact you to determine whether your claim is covered by the warranty. Before providing warranty service, Vestil may require you to send the entire product, or just the defective part or parts, to its facility in Angola, IN. The warranty covers defects in the following *original* dynamic components: motors, hydraulic pumps, electronic controllers, switches and cylinders. It also covers defects in *original* parts that wear under normal usage conditions (“wearing parts”): bearings, hoses, wheels, seals, brushes, batteries, and the battery charger.

### How long is the warranty period?

The warranty period for original dynamic components is 90 days. For wearing parts, the warranty period is 90 days. The warranty periods begin on the date when Vestil ships the product to the warrantee. If the product was purchased from an authorized distributor, the periods begin when the distributor ships the product. Vestil may, at its sole discretion, extend the warranty periods for products shipped from authorized distributors by *up to* 30 days to account for shipping time.

### If a defective part is covered by the warranty, what will Vestil do to correct the problem?

Vestil will provide an appropriate replacement for any *covered* part. An authorized representative of Vestil will contact you to discuss your claim.

### What is not covered by the warranty?

1. Labor;
2. Freight;
3. Occurrence of any of the following, which automatically voids the warranty:
  - Product misuse;
  - Negligent operation or repair;
  - Corrosion or use in corrosive environments;
  - Inadequate or improper maintenance;
  - Damage sustained during shipping;
  - Collisions or other incidental contacts causing damage to the product;
  - Unauthorized modifications: DO NOT modify the product IN ANY WAY without first receiving written authorization from Vestil. Modification(s) might make the product unsafe to use or might cause excessive and/or abnormal wear.

### Do any other warranties apply to the product?

Vestil Manufacturing Corp. makes no other express warranties. All implied warranties are disclaimed to the extent allowed by law. Any implied warranty not disclaimed is limited in scope to the terms of this Limited Warranty.

