

PIG Non-Slip Epoxy Tread Kit

Installation Instructions

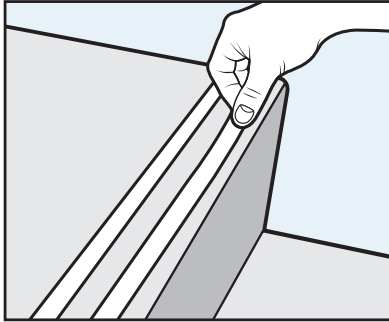

1. Apply tape form (included) to desired tread location, creating a 1" space between tape edges.

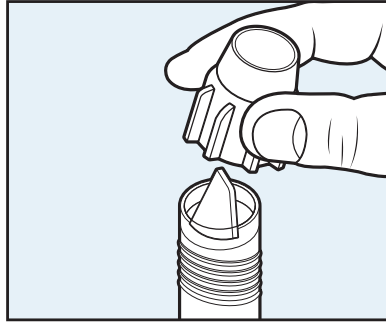

2. Unscrew cap from cartridge and remove plug.

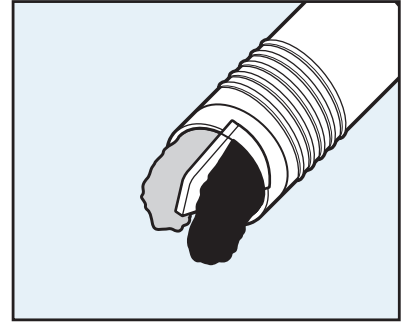

3. Dispense a small amount of material until both sides flow evenly.

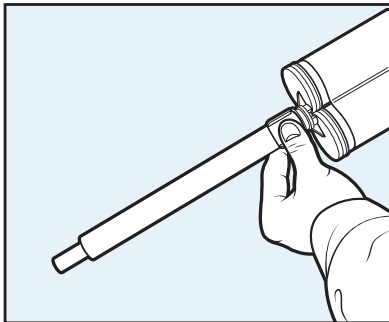

4. Screw on mix nozzle and dispense again to discard first 2" of material.

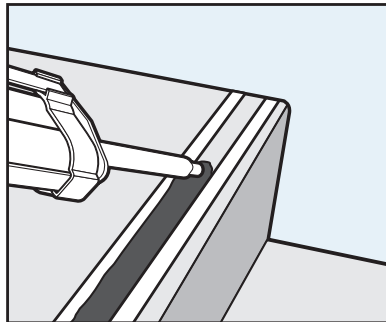

5. Insert cartridge into epoxy gun (FLM865 sold separately) and apply material to entire length of tread.

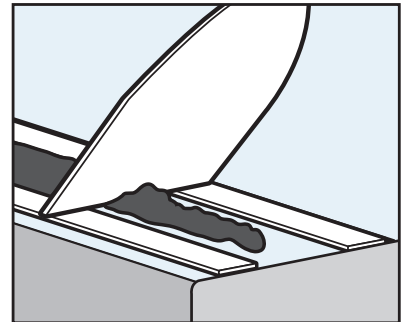

6. Spread material to the level of your tape form using included plastic putty knife.

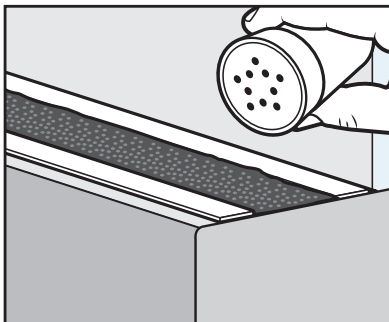

7. Sprinkle on heavy-duty grit for extra traction (included with kit FLM856, sold separately with other kits).

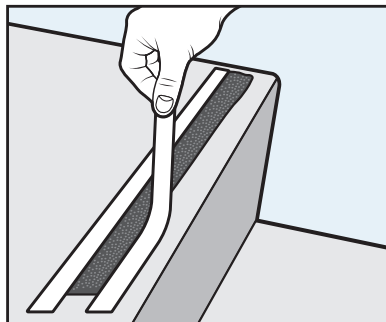

8. See cartridge for specific cure times and when to remove tape.



New Pig

One Pork Avenue
Tipton, PA 16684-0304

newpig.com

North America: **1-800-468-4647**

Europe: **+31 (0)76 596 92 50**

China: **+86-21-400 921 5178**

PIG, PIG logo are registered trademarks in USA and other countries. See tm.newpig.com

UK: **0800 919 900**

Outside North America: **+1-814-684-0101**

502878 / 361104